

Axis of Spin

architecture

AOS. architecture (Axis of Spin) was named in honour of the spinning stars in the universe, each one staying true to its own axis no matter where or how that star moves across the sky. This runs counter to the chaos of movement we experience on earth. However we each set our own axis, one that's central to our own movements, marking the home base that we can always return to. That centre, the core of our base, is grounded by a set of principles – integrity, excellence, innovation, partnership, and exploration.

The world is a reflection of the mind. Our work simply mirrors who we are, what we think, what choices we make and the values we live by. Architecture is not only the building itself. It is the building of relationships between man, nature and the environment, both physically and metaphysically.

THE SPACE OF THINKING, THE THINKING OF SPACE

To us, each design opportunity is a thinking and re-thinking opportunity. Every project is an opportunity for exploration, discovery and contribution. Each brings together a group of people who are willing to work, think and create together. Many of our clients are integral partners along the path of design and decision making.

AOS views architecture as a tool of investigation, interrogation, questioning, creation and innovation. Each project commands a unique situation, since its parameters, site, conditions and people are never the same. Furthermore, architecture is a complicated process, because it is an amalgamation of many

peoples' ideas, ambitions and aspirations. Every project we view unique, and aims to create the best benefits for client, the team and the project.

Quality in both Design and Management is demanded by our office. Each project is viewed as individual case and being served as unique situation. After detail analysis, **Strategic Approach** is being developed to achieve the best results for clients and users within the time and budget parameters.

As architects we have significant influence on our environment, AOS is committed to the integration of **Environmental Concern** in our projects.

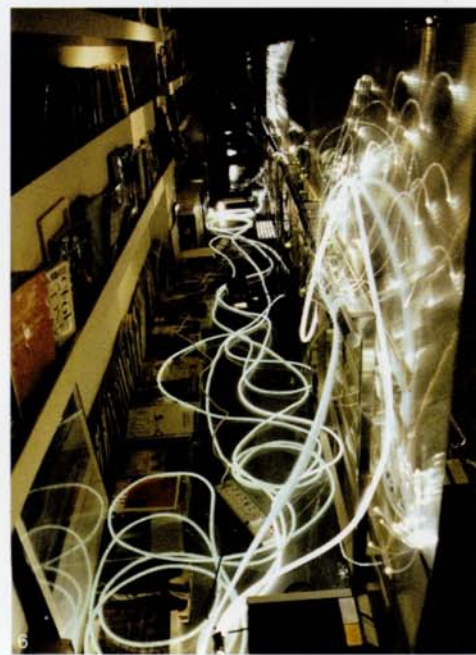
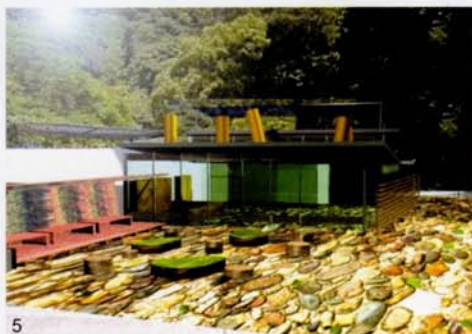

Axis Of Spin. architecture

1002, 88 Wellington Street, Central, HK
Tel: (852) 2850 6950 Fax: (852) 3421 0996

Director

CORRIN CHAN B.A. (A.S.) (Hons.) B. Arch
Master of Architecture in Urban Design
Columbia University
HKIA, Registered Architect, AP (List 1)

Associate

IVAN LAM BAAS(HKU) MArch(HKU)
HKIA, Registered Architect, AP (List 1)

Founding Staff

HENRY CHEUNG M. Arch, HKU
KENNY HUNG M. Arch, HKU

於1999年成立，以香港為基地，AOS主要服務地區為香港及中國。我們的服務包括建築設計、室內設計、城市設計及工程項目管理。員工為專業建築師及香港政府認可人仕，香港建築師學會會員。

AOS以高質素設計及管理為目標，以人為本，建立合作關係，為每項工程創造最高的效益。

對於每項工程，不論性質，我們亦處之以誠，獨立分析，建立發展策略，在時間和資金的範疇內達到最高的成效。

為達到最高效益，我們著重伙伴關係及團隊精神。有關的客戶、顧問、承建商、供應商都視為我們達到目標的伙伴。

建築對人和環境有重要的影響，作為建築師，我們承諾在我們的工程推廣「綠色」和「環保」概念，為人類和環境減少破壞。

我們過往的工程包括高級會所及示範單位、幼稚園、教堂、社區健康中心、婦女庇護中心、老人中心、東莞工廠，商業及住宅工程項目。

- 1 St. Thomas Church
- 2 St. Thomas Church
- 3 St. James Settlement Continuing Health Center
- 4 Kokido Office, Hong Kong
- 5 Kadorie Farm Guest Reception Center proposal
- 6 AOS exhibition at Architude
- 7 Kokido Office, Ning Bo
- 8 Rocom China, Staff Canteen
- 9 'Tuen Mun is an Off-Spin'
- 10 HighCliff Clubhouse
- 11 HighCliff Showflat
- 12, 13 HighCliff Clubhouse
- 14 HighCliff Showflat

